

t-max

VERTICAL MIXERS

www.t-max.com.tr

Vertical Mixer for granules and rigid flakes mixing, available in different sizes and capacities. Realized in painted steel and stainless steel AISI 304. In option uploading cells, top unloading pipe to fill the big-bag, forced load to a faster big-bag emptying, timer pause/work on the electrical panel. On request, versions with a capacity up to 50.000 liters. Available version on wheels up to 2.450 liters.

FEATURES:

- » Ideal for mixing of grains and ground products.
- » Wide range of models with volumes from 300 to 16,000 litres.
- » Reliability and Safety for the operators.
- » Product loading with incorporated hopper.
- » Large hatches for easy inspection and cleaning.
- » In-hopper unloading for mixing control.
- » Application of special outlet for connection to flexible or pneumatic mechanical conveyors
- » Stainless steel and specially constructed versions available on request.
- » Available in versions from 180 to 500 litres.
- » Fitted with wheels: can be used on several machines and positioned even where space is limited.
- » Can be connected to flexible and pneumatic conveyors.
- » The MM2.ED series is equipped with an incorporated, automatically controlled heater to provide hot air.

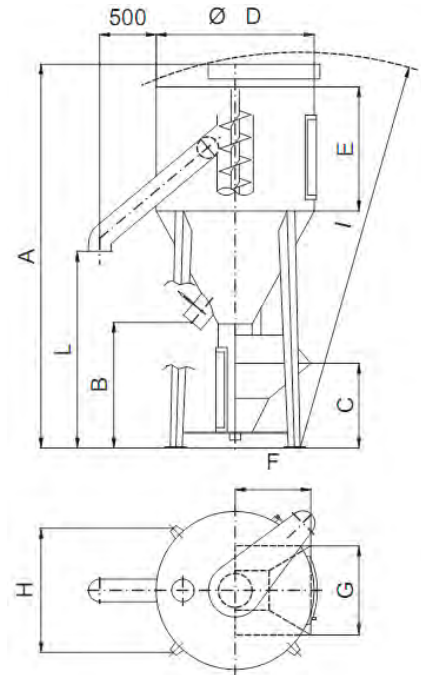

| Model | Capacity (kg)* | A | B | C | D | E | F | G | H | I | L | kW | Weight |
|-------------|----------------|------|------|-----|------|------|-----|-----|------|------|------|------|---------|
| TX-VM 500 | 300 kg | 2590 | 1165 | 670 | 1000 | 650 | 600 | 650 | 1010 | 2700 | - | 1,5 | 250 kg |
| TX-VM 1000 | 600 kg | 2950 | 1165 | 670 | 1000 | 1000 | 600 | 650 | 1010 | 3040 | - | 2,2 | 330 kg |
| TX-VM 1800 | 1000 kg | 3350 | 1175 | 700 | 1400 | 1100 | 650 | 750 | 1280 | 3462 | - | 4,0 | 450 kg |
| TX-VM 2500 | 1500 kg | 3765 | 1180 | 800 | 1700 | 1250 | 750 | 900 | 1510 | 3933 | - | 5,5 | 580 kg |
| TX-VM 3500 | 2000 kg | 4015 | 1180 | 800 | 1700 | 1500 | 750 | 900 | 1510 | 4175 | 1800 | 7,5 | 780 kg |
| TX-VM 5000 | 3000 kg | 4515 | 1180 | 800 | 1700 | 2000 | 750 | 900 | 1510 | 4656 | 1800 | 9,0 | 940 kg |
| TX-VM 8000 | 5000 kg | 4975 | 1180 | 800 | 2200 | 2000 | 750 | 900 | 1860 | 5141 | 1800 | 11,0 | 1250 kg |
| TX-VM 10000 | 6000 kg | 5470 | 1180 | 800 | 2200 | 2500 | 750 | 900 | 1860 | 5626 | 1800 | 11,0 | 1380 kg |
| TX-VM 12000 | 7200 kg | 5970 | 1180 | 800 | 2200 | 3000 | 750 | 900 | 1860 | 6105 | 1800 | 15,0 | 1500 kg |
| TX-VM 15000 | 9000 kg | 6115 | 1160 | 800 | 2500 | 3000 | 750 | 900 | 2090 | 6280 | 1800 | 15,0 | 1650 kg |
| TX-VM 16500 | 10.000 kg | 6415 | 1160 | 800 | 2500 | 3300 | 750 | 900 | 2090 | 6575 | 1800 | 15,0 | 1700 kg |
| TX-VM 20000 | 12.000 kg | 7200 | 1160 | 800 | 2500 | 4000 | 750 | 900 | 2020 | 7350 | 1800 | 15,0 | 2950 kg |
| TX-VM 28000 | 17.000 kg | 7700 | 1170 | 830 | 2950 | 3800 | 750 | 900 | 2250 | 8200 | 1800 | 15,0 | 3350 kg |

* Bulk density is based on 0.6 kg/dm³.

NOTE: The heating function is optional.

Mixing silos for plastic materials have been planned and built for making the best mixings of granules and/or grinded products; they are moreover suitable for colouring with master or pigments. They are made of painted carbon steel (mod "TV") or in stainless steel (mod."TX"), with capacities from 500 to 28.000 litres (available on demand bigger volumes) Vertical Mixer for granules and rigid flakes mixing, available in different sizes and capacities. Realized in painted steel and stainless steel AISI 304. In option uploading cells, top unloading pipe to fill the big-bag forced load to a faster big-bag emptying timer pause/work on the electrical panel Optimized version for the container transportation with a maximum diameter of 2100mm.

OPTIONALS

- » Large door on cylinder and cone + door along inside screw pipe for better and frequent cleanings.
- » Hinged cover for standard loading hopper.
- » Loading hopper mt. 1x1 for receiving products from big-bag.
- » Additional unloading pipe for big-bags filling.
- » Upper tangential inlet for pneumatic loading.
- » Loading cells.
- » Wheels for mixer moving (only for models up to 5000 litres)
- » Level indicators

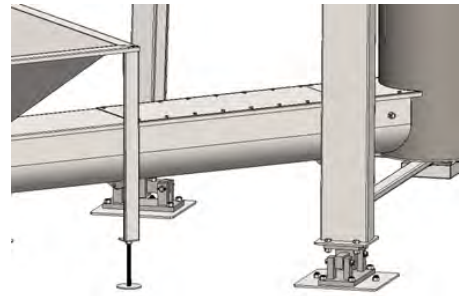

Electronic Control Load Cell

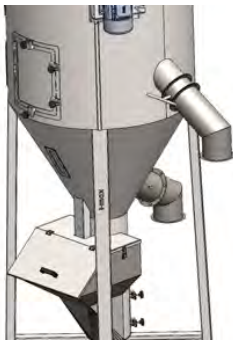

Big-Big side filling and manual shutoff valve



Feeding from big-bag

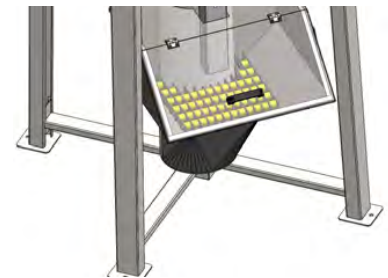

Magnet for Hopper



Drying Option



Pneumatic Discharge Valve + Control

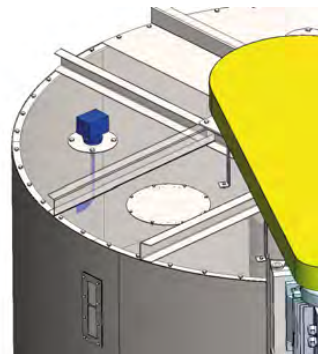

Maximum Level Control

t-max

Tepro Makina ve Otomasyon Sistemleri San. ve Tic. A.Ş.
İnönü Mah. Gebze Güzeller OSB, Nursultan
Nazarbayev SK. No:14, 41400 Gebze / Kocaeli
+90 (216) 709 26 00

www.t-max.com.tr